



## COLORS

RAL	SILVER	PANNA	CHOCCHO	AZZURRO	LI MOINE	LI ME	LAMARENA	PESCA
RAL	SILVER	RAL 90 0	RAL 8014	PANTONE 285	PANTONE 394	PANTONE 383	PANTONE 233	PANTONE 165

## FEATURES



## KEY FEATURES

- Maxi display volume perfectly refrigerated
- No wire LED light system
- Double glazed glasses with no fog system
- Hinged double glazed doors on the operator side
- Assisted tilt down front glass opening system
- Automatic defrost: electric on the refrigerator version (+4°C); reverse cycle on the freezer version (-20°C) with three phase semi hermetic compressor
- Perfect product visibility all over the sides

Full refrigerated display showcase. Positive temperature (+4°C) and negative temperature (-20°C) for frozen cakes. Display structure completely realized in double glazed with self-closing doors on the operator side. N° 4 Glass shelves with shining S/S adjustable brackets. No wire LED light on the top and inside each shelf. Assisted tilt down opening system of the front glass. Built-in condensing unit. Shining S/S basement carter

# MYA PLUS

## SECTIONS AND MODELS

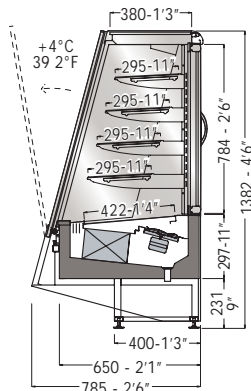

**MYA PLUS PASTRY - COLD**

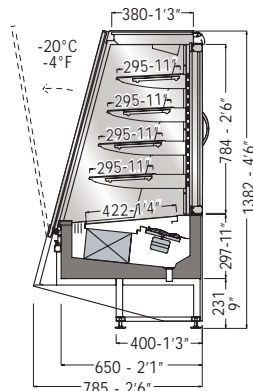

**MYA PLUS PASTRY - FROZEN**

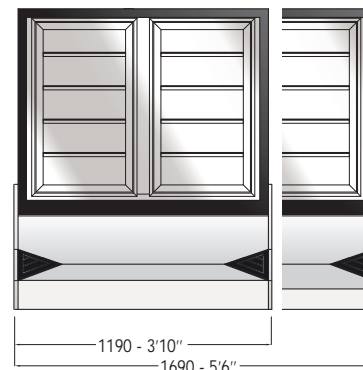

TECHNICAL FEATURE		POSITIVE TEMP. (COLD) - VERSIONS		NEGATIVE TEMP. (FROZEN) - VERSIONS	
		1150	1650	1150	1650
External dimensions (L-D-H)	inches mm	467% - 307% - 543% 1190-785-1382	66½% - 307% - 543% 1690-785-1382	467% - 307% - 543% 1190-785-1382	66½% - 307% - 543% 1690-785-1382
Crated dimensions (L-D-H)	inches mm	54¾% - 38¾% - 63¾% 1390-980-1620	78 - 38¾% - 63¾% 1390-980-1620	54¾% - 38¾% - 63¾% 1390-980-1620	78 - 38¾% - 63¾% 1390-980-1620
Refrigeration	Type	Fan Ventilated	Fan Ventilated	Fan Ventilated	Fan Ventilated
Refrigerated display area	Type	Deck / Shelves	Deck / Shelves	Deck / Shelves	Deck / Shelves
Operating temperature	°C / °F	+4 / 39.2	+4 / 39.2	-20 / 39.2	-20 / 39.2
Compressor	nr. / Type	1 / hermetic	1 / hermetic	1 / semi-hermetic	1 / semi-hermetic
Cooling power *	(W)	930	1160	1400	1780
Electric supply	(V/ph/Hz)	230/1/50 (UE) 120/1/60 (USA)	230/1/50 (UE) 120/1/60 (USA)	400/3/50 +N (UE) 230-208/3/60 (USA)	400/3/50 +N (UE) 230-208/3/60 (USA)
Power consumption	(W/A)	1000/5,8	1200/8,5	3800/9,0	4700/12,5
Defrost	Mode / type	electric	electric	invert cycle	invert cycle
Climatic class	N°/°C(F°)/H.R.	4+/35(95)/70%	4+/35(95)/70%	4+/35(95)/70%	4+/35(95)/70%
Refrigerant Gas	Type	R404A	R404A	R404A	R404A
Net weight	Kg / Lb	170 / 374	220 / 485	170 / 374	220 / 485
Crated weight	Kg / Lb	260 / 573	340 / 749	260 / 573	340 / 749

### STANDARD FEATURE

- LED lighting system
- Front, top and side double glasses
- Remote condensing unit

### OPTIONAL

- Dual temperature switch  
(-20°C / +4°C) (-4°F / +39.2°F)

\* At -12°C of expansion for Cold version  
At -37°C of expansion for Frozen version

The company reserves the right to make modifications to the products without prior notice.

CIAM s.p.a. | Viale dei Pini 9 | 06081 | Petignano di Assisi | PG - Italy | Tel: 0039 07580161  
web: [www.ciamweb.it](http://www.ciamweb.it) | mail: [info@ciamgroup.it](mailto:info@ciamgroup.it)

2017 / v1.0

# MYA PLUS



**CIAM**  
REFRIGERATION DESIGN